

1

2

3

4

A

A

B

B

C

C

D

D

E

E

F

F

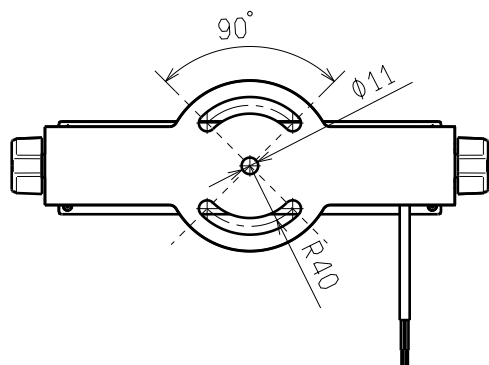
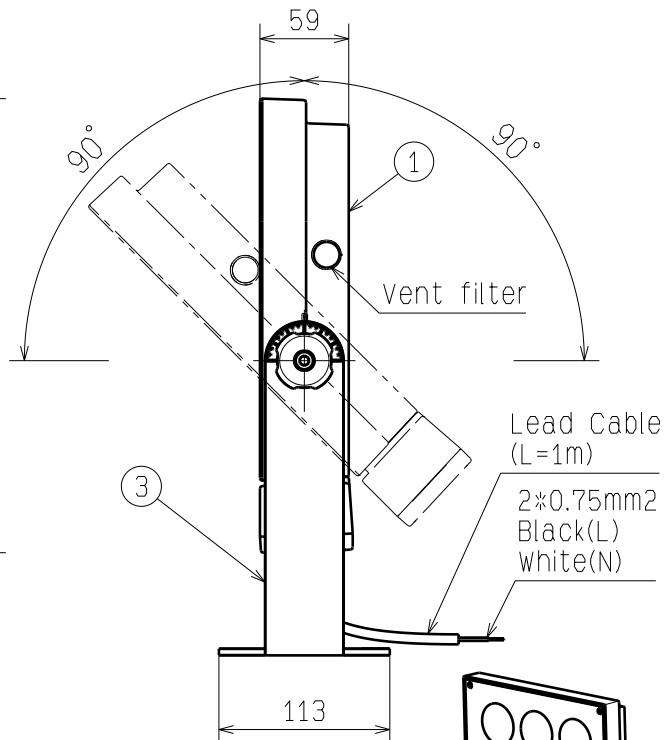
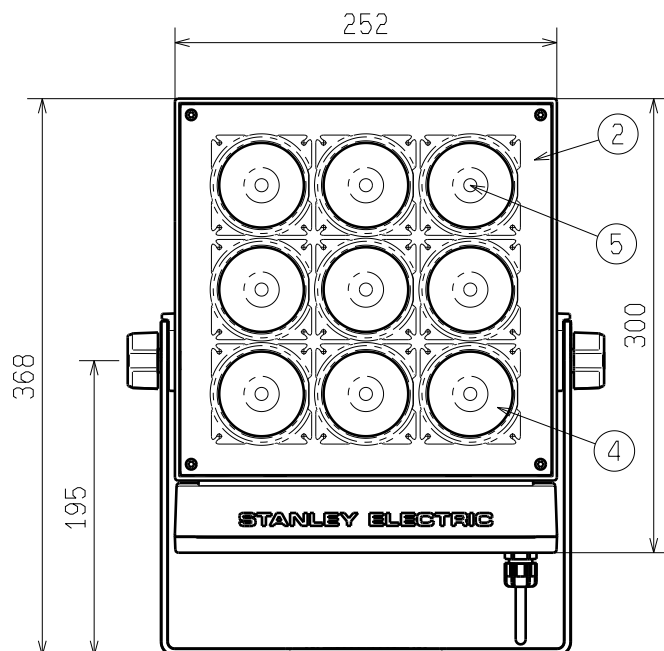

Color temperature	5000K
Color rendering index	70
1/2 beam angle	2.5°
Center luminous intensity	1,049,430cd
Wind pressure resistance	60m/s
Projected area	0.080m²
Waterproof and dustproof	IP66
Impact resistance	IK08
Weight	5.2kg
Body color	Charcoal gray

Input voltage	100~240VAC
Power consumption	35.7W (100VAC)
Input current	0.397A (100VAC)
Frequency	50/60HZ
Operating temperature	-40°C~50°C

5	LED		9	
4	Lens	PMMA	9	
3	Bracket	Steel plate (t4.5)	1	Heavy salt resistance coating
2	Shade	Polycarbonate	1	
1	Housing	Aluminum die-cast	1	Heavy salt resistance coating
NO.	Name	Material	Quantity	Remarks

材質 MATAL.	設計 DGN.	検図 CHK.	品名コード	PART CODE
処理 FINISH	Uchiyama	Naka jima	8501879500	
質量 MASS	5.2kg	制定日 DWG. DATE	承認 APP.	品名 NAME
		2019.11.12	Ito	LLF0111A_LWWD03550XVNSBKSCCE1

尺度 SCALE	1 : 5	スタンレー電気株式会社		図番	DWG. NO.
単位 UNIT mm		STANLEY ELECTRIC CO., LTD.		(P#:D05F)	

## CAUTION:

- This product is for general outdoor or indoor use only.
- The wind pressure resistance is 60m / s. Do not install in places where the wind speed exceeds it to avoid fall of the fixture.
- The product must be used with the specified input voltage and frequency.
- The product must be used at an ambient temperature of -40 to 50 °C. During the daytime, do not use it except for temporary operation check.
- When the product is used in cold areas, do not install at places where icicles can fall.
- The product surface becomes hot during operation or immediately after it is turned off. Be careful when touching the product.
- Do not install the product in places containing sulfur component such as hot spring.
- Do not install the product towards the sun. Concentrated sunlight may damage the LED and result in malfunction or fire.

## ⚠ WARNING

- This product must be installed in accordance with the installation instructions to avoid malfunction, fall of the fixture, electrical shock or fire.
- Do not use the product in places where the humidity exceeds 90% RH, vibration or shock are transmitted to the fixture, there is much oil mist or corrosive gas, or indoor pools that use chlorine.
- Do not disassemble or modify the fixture
- Do not operate the product when it is damaged.
- If there are abnormalities found in the product such as smoke or unusual odor, disconnect power immediately and contact dealers.

品名コード	PART CODE
8501879500	
品名	NAME
LLF0111A_LWWD03550XVNSBKSCCE1	
図番	DWG. NO.
D000202244B	(P#:D05F)